

# Remote Condenser

## NW ice machine models

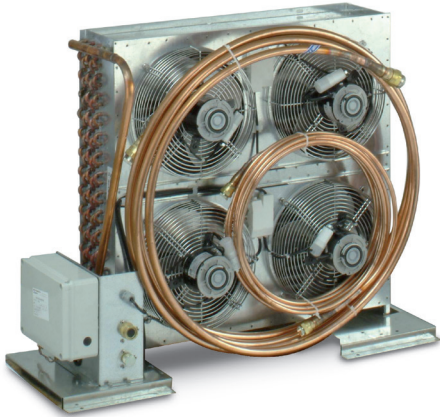

### FEATURES

- Operate in wide outdoor temperature range from +5°C to 50°C.
- Single piping circuit for single unit installation.
- Heavy gauge galvanized steel for corrosion resistance.
- Thermally protected fan motors.
- PVC coated steel fan guards.
- Direct drive fan blades.
- Standard Aero-Quip fittings.
- Maximizes ice production by dissipating heat away from ice machine.
- Minimizes air conditioning load.

### TUBE LINE SETS

Pre-charged, insulated, refrigerant line sets with easy to install quick-connect couplings (10 meters).

OPERATING REQUIREMENTS			REFRIGERANT GAS	VOLTAGE V/Hz/ph
	Minimum	Maximum		
Air temperature for Standard Version	+5°C	+43°C	R404A	230/50/1
Air temperature for Tropical Version	+5°C	+50°C	R452A	
Electrical voltage	-10%	+10%		

Model number	Matching ice machines	Version	Unit size (W x D x H) mm	Unit weight kg	Shipping size (W x D x H) mm	Shipping weight kg
SCRMTCD NW01008	NW 1008	Standard	748 x 511 x 578	25	850 x 550 x 750	35
SCRMTCD NW01408	NW 1408	Standard	748 x 511 x 578	30	850 x 550 x 750	40

**IMPORTANT NOTICE:**  
Models and specifications are subject to change without notice. This spec sheet is meant for commercial purpose only. For technical documentation please refer to our service manuals.

Download our free App Scotsman Ice  
[Apple store](#)  
[Google play](#)  
[Windows store](#)



[www.scotsman-ice.it](http://www.scotsman-ice.it)  
[www.scotsman-ice.com](http://www.scotsman-ice.com)

Remote Condenser

# Remote Condenser

NW ice machine models

Remote Condenser

SCRMTCND NW01008

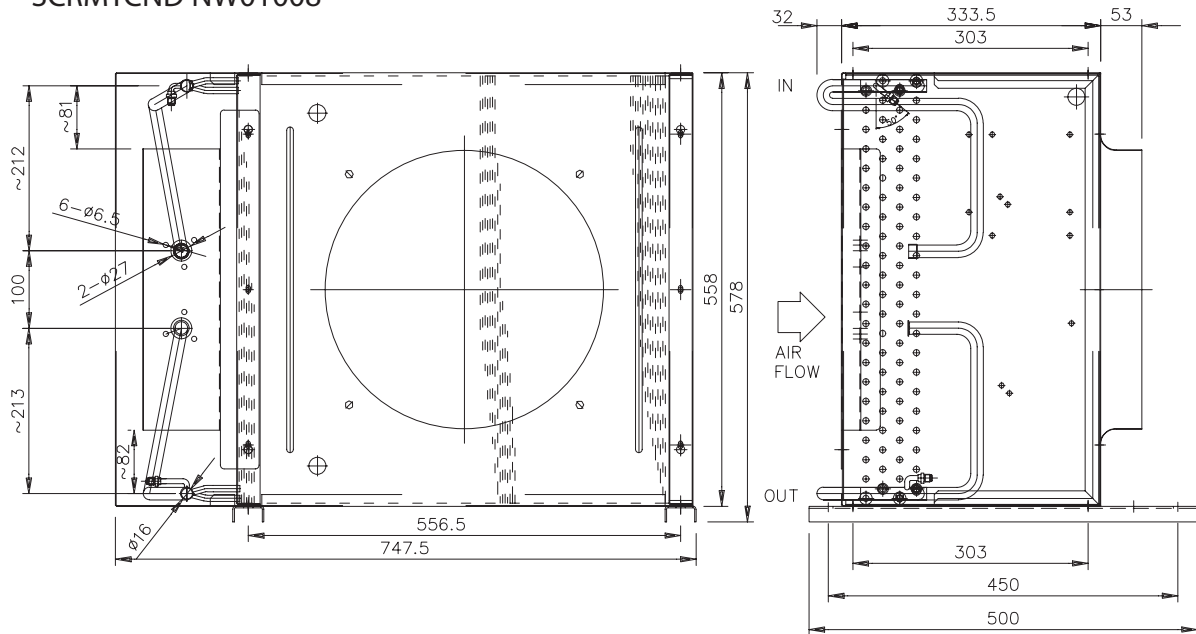

SCRMTCND NW01408

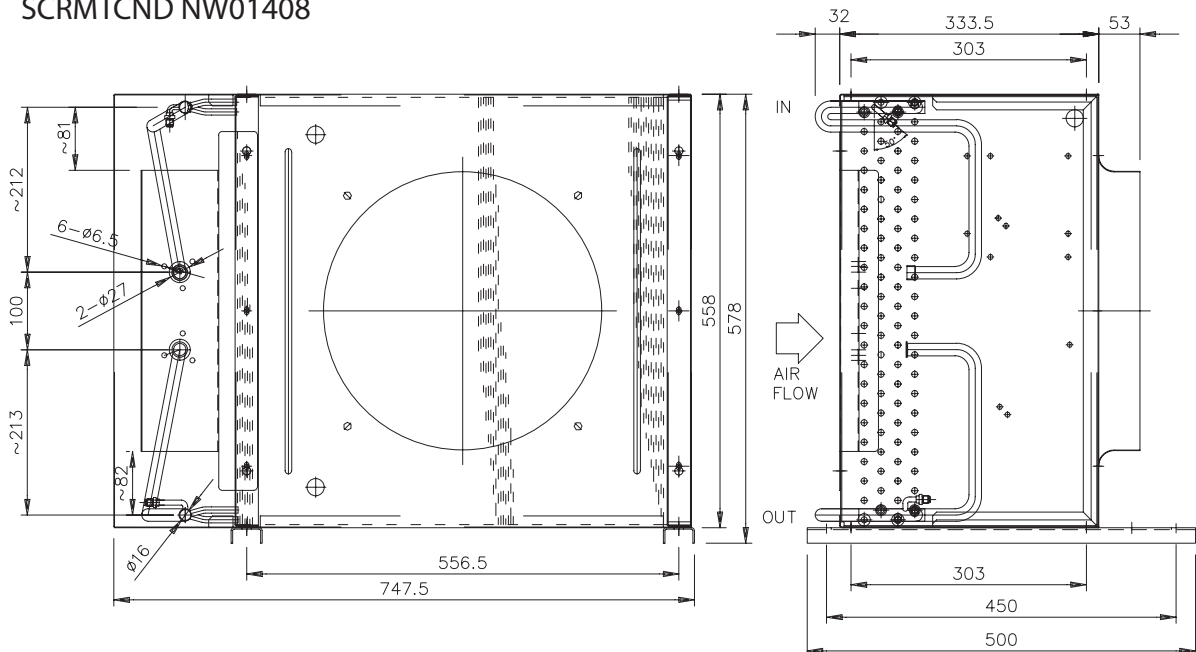

Model number	kW	Air Flow m3/h	No. fans	Electric consumption W	Amp	dB(A) 10 m
SCRMTCND NW01008	7,21	2600	1 x 350mm	180	0,85	40
SCRMTCND NW01408	9,16	2100	1 x 350mm	180	0,85	40